

Fabrication Instructions

Tilt WireFree RTS for Horizontal Blinds

Component Check List:

- A. WireFree Tilt RTS Motor (Part No. 100678)
- B. 12V Battery Reloadable Battery Tube (Part No. 9014020)
- C. Wall Mounting Clips for Battery Tube (Part No. 9013263)
- D. Headrail Adapters:
 - 2" x 2 1/4" (51 x 57mm) (Part No.9014529)
 - 1.5" x 2 1/4" (38 x 57mm) (Part No.901528)
- E. Shaft Adapters (if required):
 - 5.6mm Hex (Part No. 9014535)
 - "D" Shape (Part No. 9014536)
 - 4mm Square (Part No. 9014540)

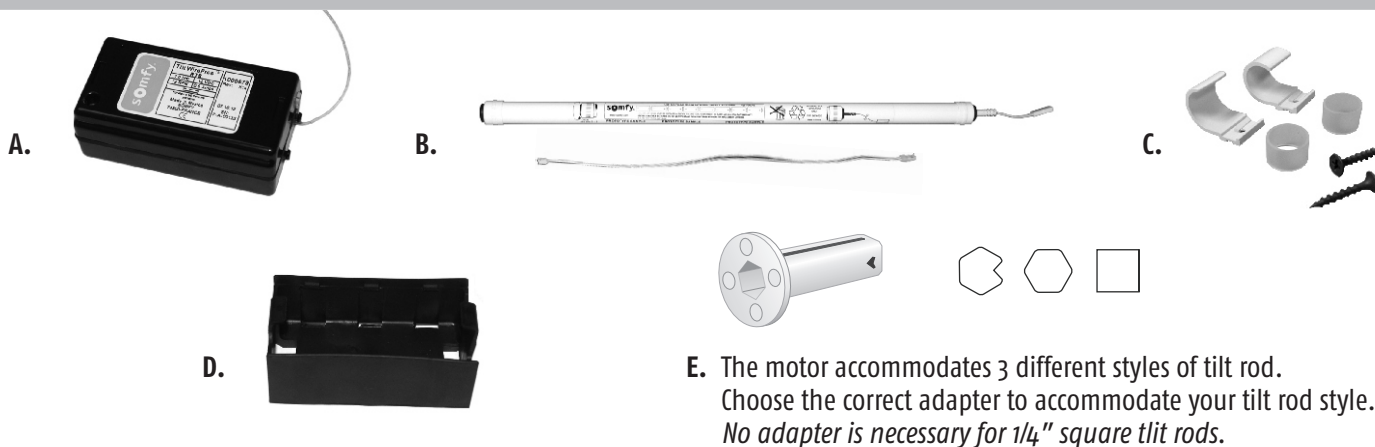

E. The motor accommodates 3 different styles of tilt rod. Choose the correct adapter to accommodate your tilt rod style. *No adapter is necessary for 1/4" square tilt rods.*

Recommended Tools:



Dremel Tool with Cutoff Wheel or Hack Saw

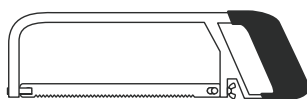

Round or Rat Tail File

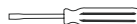

Flathead Screwdriver



Hammer

Fabrication Procedure:

STEP 1.

Place blind on a flat surface.

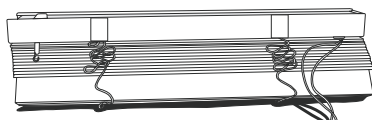

STEP 2.

Tap off both end caps.

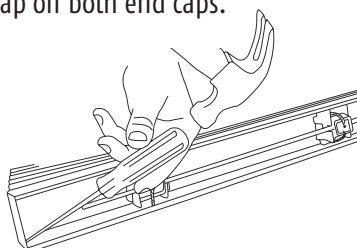

STEP 3.

Slide tilt rod out of wand or cord tilter and remove tilter.

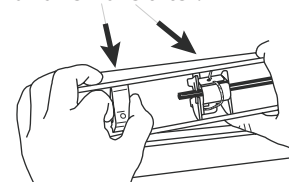

Fabrication Procedure Continued:

STEP 4.

Measure and mark tilt rod at 3.54" (90mm) from end of headrail.

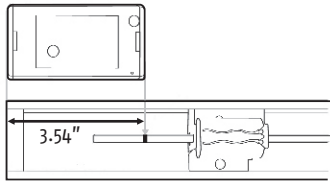

STEP 5.

Slide tilt rod from headrail until mark is visible.

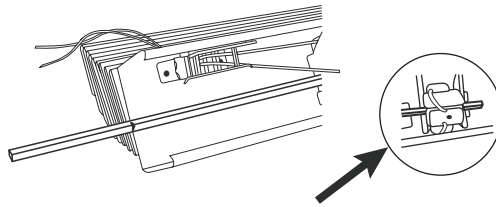

Avoid removing the tilt rod from the tilting cradle, as it may become difficult to reassemble.

STEP 6.

Cut tilt rod (at mark) using a dremel tool or hack saw.

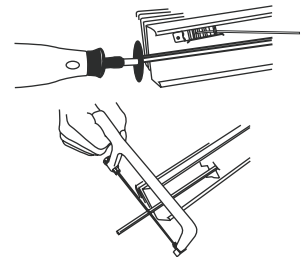

STEP 7.

File end of tilt rod to remove any rough edges.

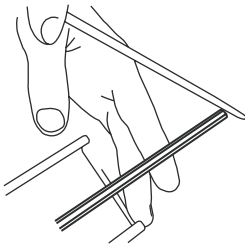

STEP 8.

Install the appropriate tilt rod (shaft adapter) if required.

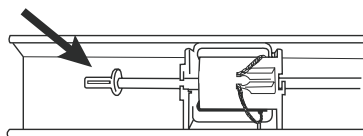

STEP 9.

Attach "C" clip or stop collar device (not included) to prevent tilt rod (shaft) from separating from motor.

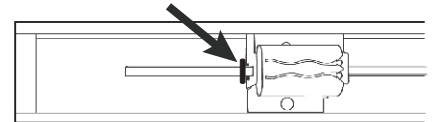

STEP 10.

Position motor into the appropriate headrail adapter securing the "snaps" on the top of the motor.

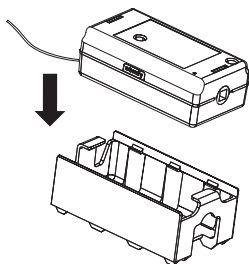

STEP 11.

Insert motor (with headrail adapter) into headrail. Be certain the tilt rod (shaft) is fully inserted into motor.

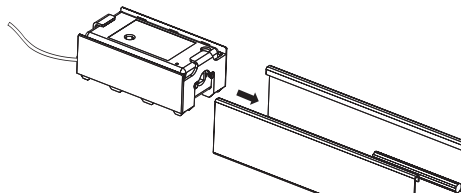

STEP 12.

Connect battery tube extension cable (provided w/ battery tube) or plug-in transformer (optional) to the motor input jack.

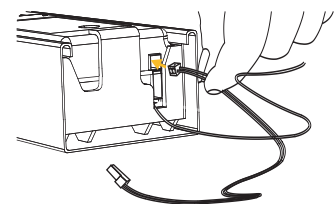

STEP 13.

Attach battery clips (with included screws) to wall or window surface and secure battery tube. Connect battery tube cable to extension cable previously attached to motor (step 12).

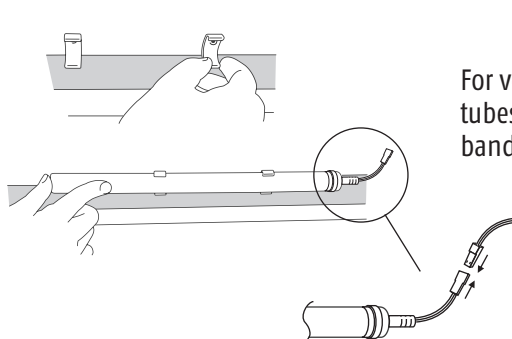

For vertical mounted battery tubes, use the provided rubber bands to secure tube.

